

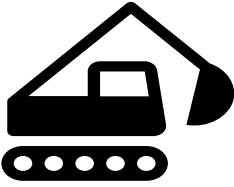



# GC600 Week 2 Traffic Update

## Construction Activities

### 17 – 22 September 2018

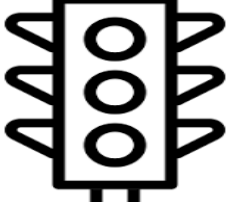
	<p><b>WORKING HOURS</b></p> <p>Monday to Saturday – 7:00am to 5:00pm          Wednesday – 3:00am to 5:00pm          Sunday – No planned works</p>
	<p><b>TYPES OF WORK</b></p> <ul style="list-style-type: none"> <li>• Concrete Barrier &amp; Debris Fence Installation</li> <li>• Grandstand &amp; Corporate Stand Installation</li> <li>• Pit Building Installation</li> <li>• Pedestrian Bridge Installation</li> </ul>
	<p><b>ROADS IMPACTED</b></p> <p><b>Main Beach Parade</b></p> <ul style="list-style-type: none"> <li>• Partial lane closures 7:00am to 5:00pm (Monday – Friday)</li> <li>• Full road closure 3:00am to 5:30am (Wednesday)</li> </ul> <p><b>Breaker Street</b></p> <ul style="list-style-type: none"> <li>• Partial lane closure 7:00am to 5:00pm (Wednesday – Thursday)</li> <li>• Full road closure 7:00am – 11:00am (Friday)</li> </ul> <p><b>Serisier Avenue/Hill Parade</b></p> <ul style="list-style-type: none"> <li>• Full road closure 7:00am – 5:00pm (Friday – local traffic only)</li> </ul>
	<p><b>TRAFFIC MANAGEMENT</b></p> <p>Traffic control measures will be in place across the works to assist the contractors and to ensure safe passage for vehicles and pedestrians.</p>
	<p><b>TRANSPORT SERVICES</b></p> <p>All public transport services along Main Beach Parade will operate as per normal.</p>



## LOCATION OF WORKS

See the maps provided below

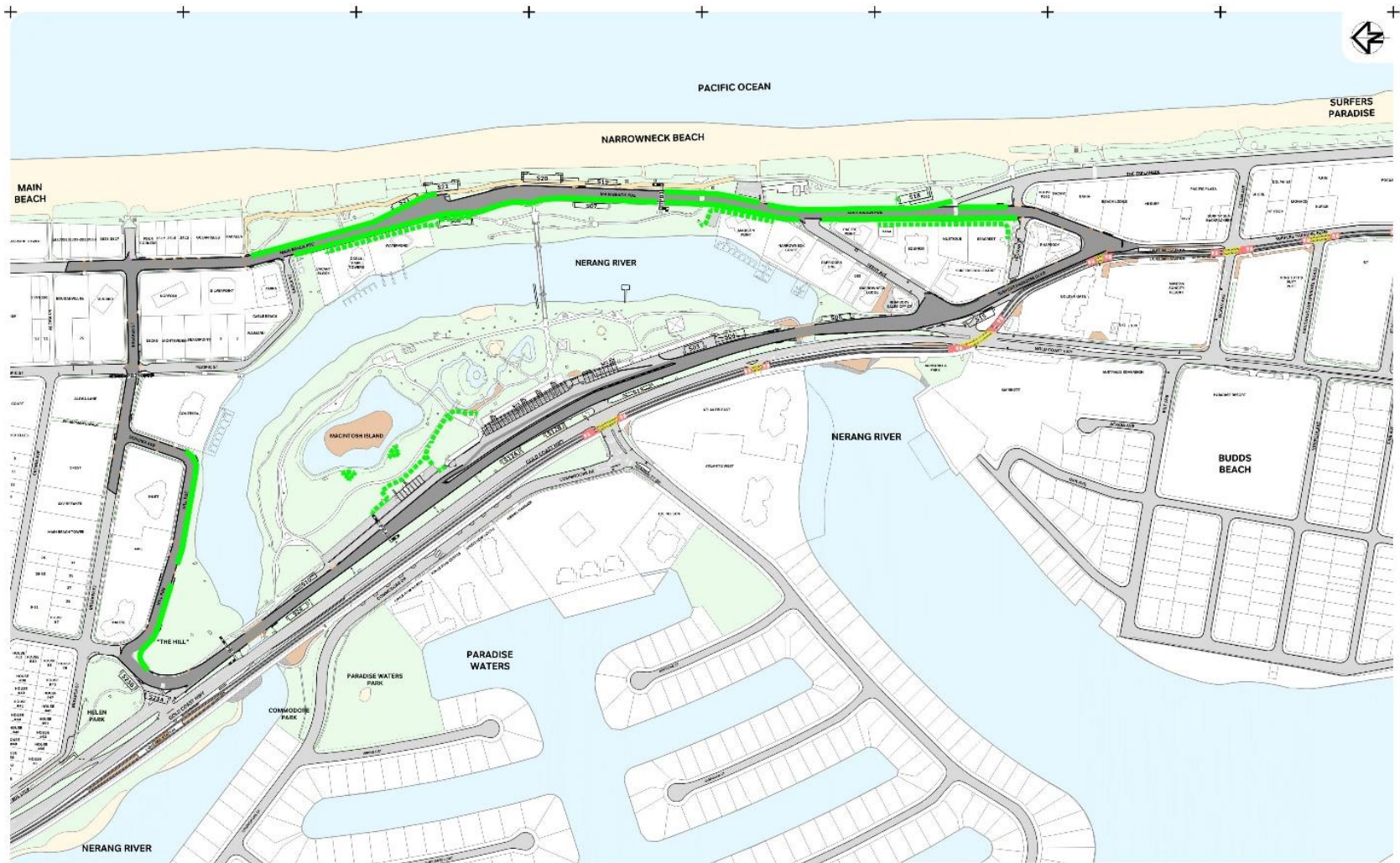

CONCRETE BARRIER WEEKLY INSTALLMENTS			1.8m SECURITY FENCE WEEKLY INSTALLMENTS		
	WEEK 1		WEEK 3		WEEK 5
	WEEK 2		WEEK 4		WEEK 6 (EVENT WEEK)



CLIENT	
SCALES	AHD
GRID	MGA-94
AUTHOR	M.Trathen
DESIGNER	M.Trathen
REVIEWER	L.Daley

PROJECT	Vodafone GOLD COAST 600 19 - 21 OCT 2018
TITLE	Concrete Barrier & Security Fence Installations Week 2: 17/09 - 22/09

<b>iEDM</b> 1 +61 7 5555 9977 www.iedm.com.au		
DWG No.	PROJECT No.	REVISION
K101	18003	01

Aug 21, 2018 - 3:59pm C:\Egnyte\Share\00\_Projects\18003 GC 600\06\_CAD\18003.dwg

© COPYRIGHT RESERVED